

Dosing systems for grotamar[®] 71 and grotamar[®] 82

Microorganisms reproduce exponential. They form bio sludge and cause microbial introduced corrosion. The bio sludge blocks filter and lead to engine failure. The operating reliability des whole fuel system is at risk. The dosage of grotamar[®] prevents the bio sludge formation.

ProMinent Dosiertechnik GmbH has already delivered numerous dosage systems for sea going vessels und yachts. A safe metering of grotamar[®] is ensured, without manual dosage during refuelling. Incidents caused by forgetfulness insufficient dosage are to prevented by safe technique.

Example of a dosage system

In the bunker line fuel meters with 4:20 mA or with potential-free contact output have to be installed by the client. This signals control a dosage pump in proportion to quantity. The appendices demonstrate some examples of dosage systems.

The size of pumps and tanks are variable.

Further information:

Frank Themsen
ProMinent Dosiertechnik GmbH
ANFP

eMail: F.Themsen@prominent.com
Telefon: +49 421 6208545
Mobiltelefon: +49 174 3255261

<http://www.prominent.com>

The information given concerning the application and product technology represent our state of knowledge at the time of going to press, and no claims are made as to its completeness. The information given does not free the user of his own responsibility for comprehensive testing before production. We therefore disclaim any responsibility for the accuracy of the information given.

Schülke & Mayr GmbH

Robert-Koch-Str. 2 | D-22851 Norderstedt | Postal address: D-22840 Norderstedt
Phone/Fax: +49 40 521 00 - 0/ -244 | sai@schuelke.com | www.schuelke.com | www.grotamar.com | www.mikrocountfuel.com

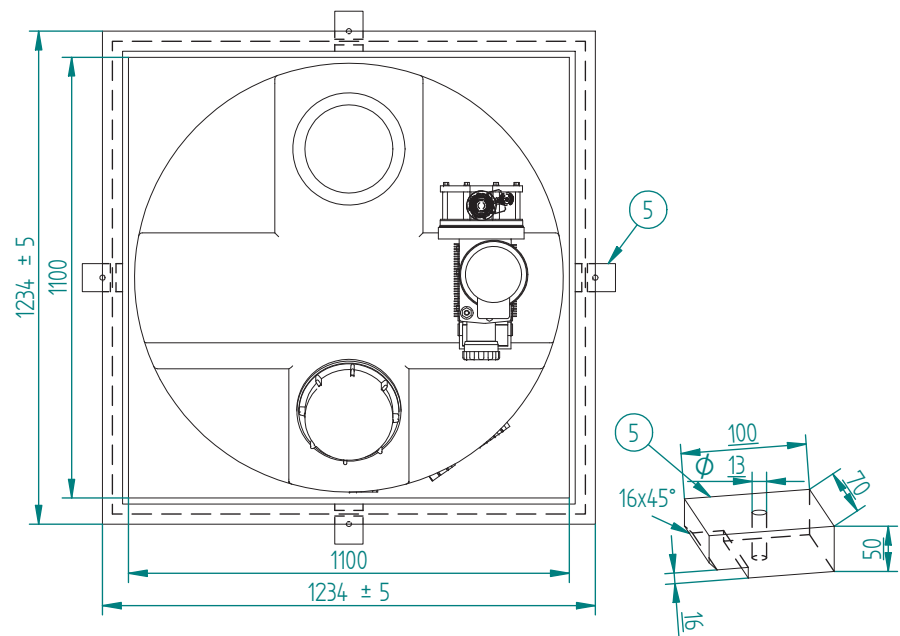
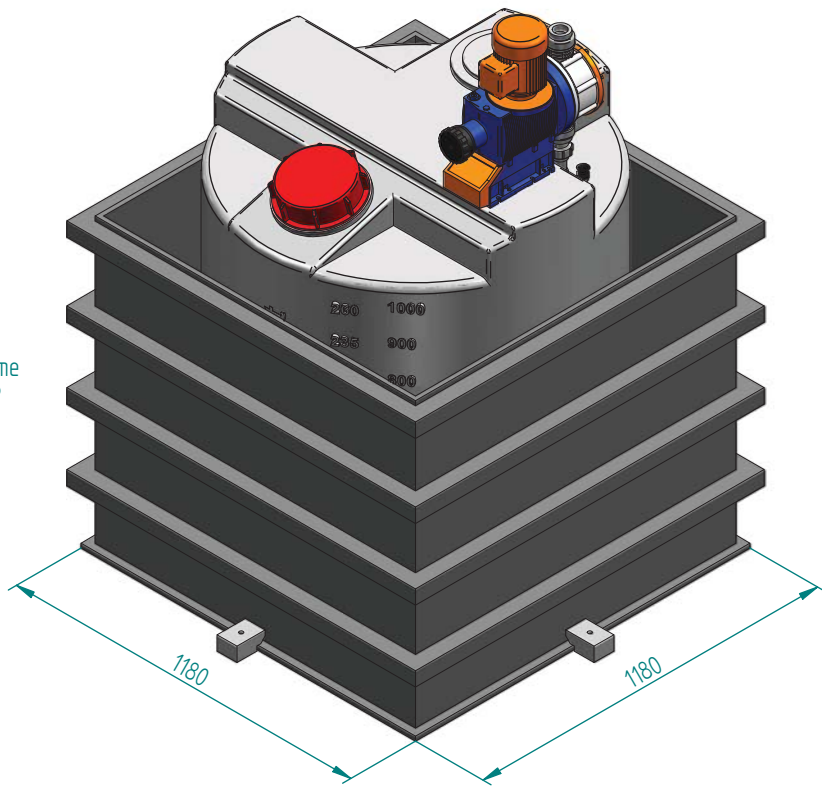
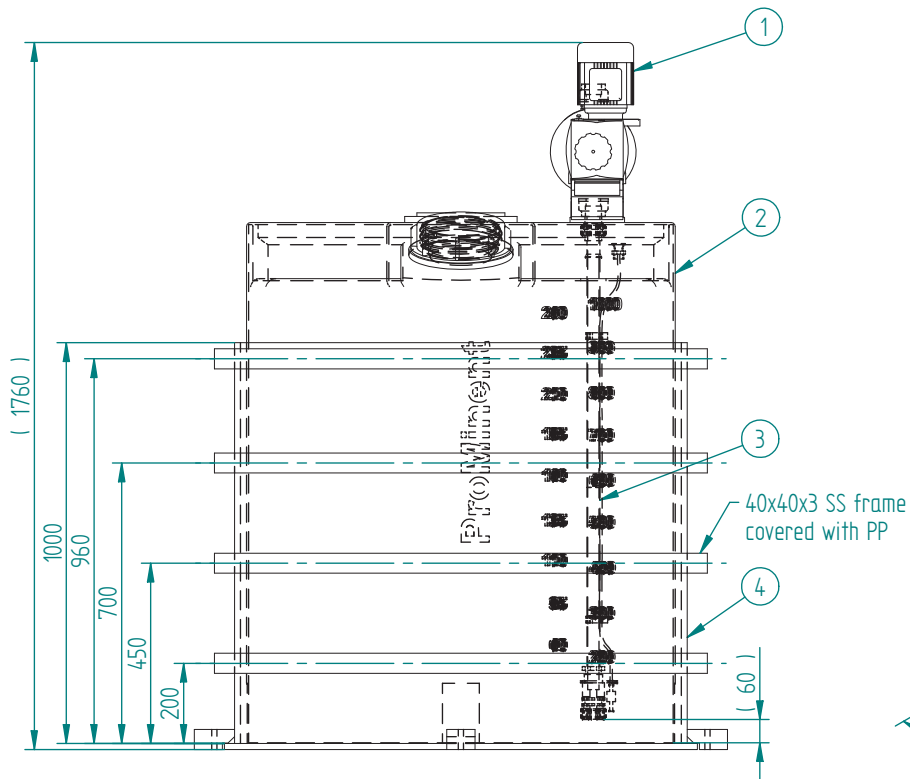

- LOSE MITGELIEFERTE TEILE:**
 1036633 DHV - 1 ST
 805288 Einlegteil - 4 ST
 803717 Dosierventil - 1 ST
 805273 Überwurfmutter - 1 ST
 805288 Einlegteil - 1 ST
 707707 Ext.-Kabel - 1 ST

Pos.	Pcs.	Description	Dimension
1	1	S3CBH120270PVTS020V0100S0DE	
2	1	PE natur tank	1000L
3	1	Suction lance	DN25
4	1	Drip pan PP	
5	4	Bodenpratzen	

Scope of application		Toler. Deviat. DIN ISO 2768v		Scale:		Weight: xy kg	
*				Material:			
07				Name			
06			Drawn	*			
05			Checked	*			
04							
03							
02							
01							
00	*	New drawing					
Rev	Date	Name	Modification	Fugnerova 567, 33601 Blovice, CZ Tel. 378 227100 fax. 378 227588			
			Origin:	1000Ldft			
				Dosierbehälterstation			
				*			
				Sheet 1/1			

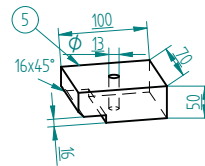
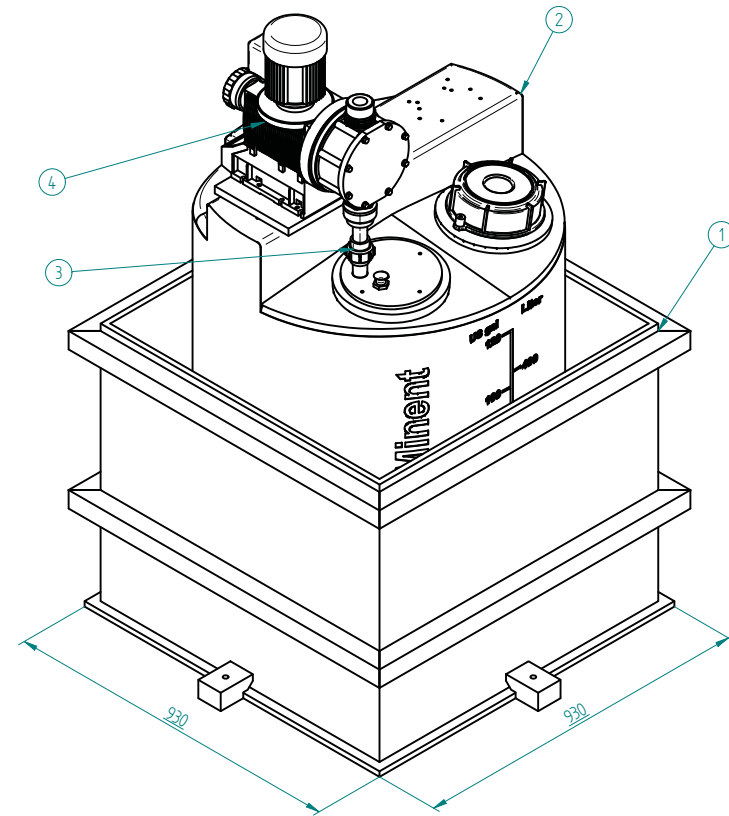
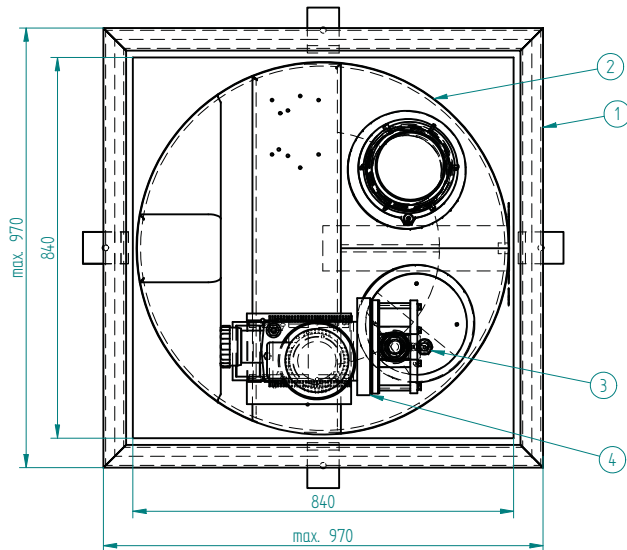
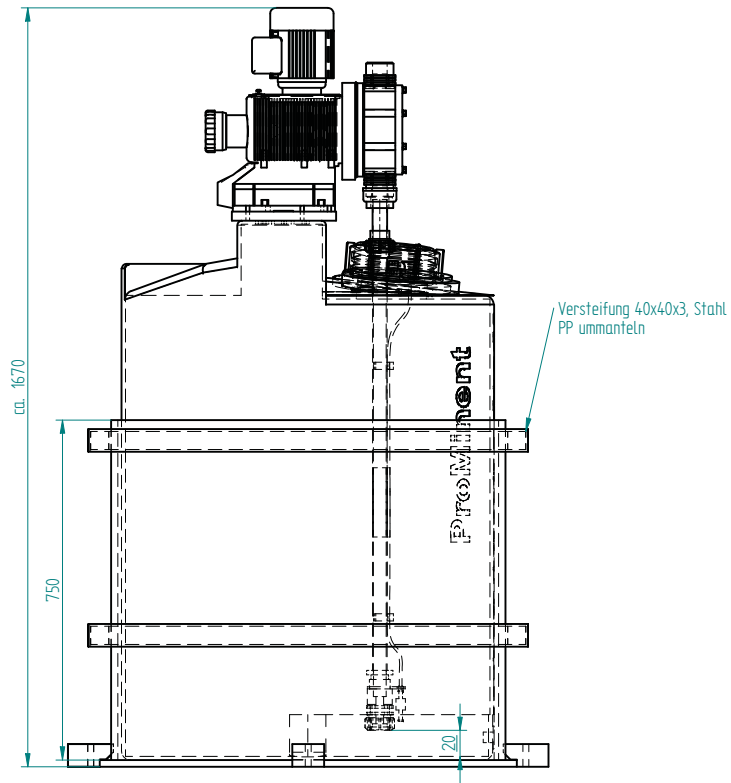

Gewicht: Auffangwanne 90kg
 Dosierbehälter 25kg
 Sigma3 25kg
 Total Gewicht: 140kg

5	4	Bodenplatte PE- lose beigelegt			
4	1	Pumpe SIGMA 3 S3CB120270PVT5200UA100SODE			
3	1	Sauggarnitur DN25, PP/EPDM, mit 2 Stufig Niveauschalter, TNr:790396	25		
2	1	Dosierbehälter 500ltr PE-natur			
1	1	Rechteckwanne PP			
Item.	Pcs.	Description	DN	DA	G

Scope of application		Toler. Deviat.		Scale		Weight	
•		DIN ISO 2768v		•		xy kg	
Material:		•		•		•	
07			Name	Dosierbehälterstation			
06		Drawn	•				
05		Checked	•				
04							
03							
02							
01							
00		New drawing					
Rev	Date	Name	Modification	Origin	500L.dft		